



Permanent Shower Curtain Rod Installation instructions

Follow these instructions for a quick and easy installation

- We recommend that two people do the installation.
- Remove the protective white caps from the rod ends before installation.
- Please make sure you have identified and located all components, hardware and tools prior to installation and have read all the instructions.
- Before starting, cover your drain. Lay each component on a soft surface to prevent damage to the product finish.

 Some steps require two people

Parts :

- A Support for the large end of the rod Support for
- B the small end of the rod
- C Expandable rod
- D Screw x 6 
- E Anchor x 6 

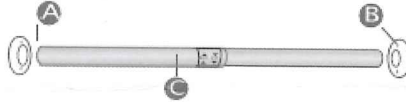

You will need :

- Pencil
- Drill
- Measuring Tape
- Hammer

Step 1: Marking grill location

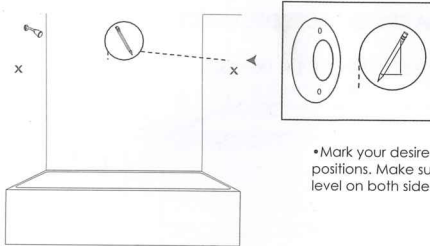

•Mark your desired installation positions. Make sure the marks are level on both sides.

Step 2: Drilling the holes and inserting the anchors

- On the left side of the tub, drill two holes into the dry wall or the tiles where marked in Step 1, using a 3/16" (5 mm) drill bit.
- Using a hammer, fully insert the anchors (E) into the holes so the edges of the anchors are flush with the wall.

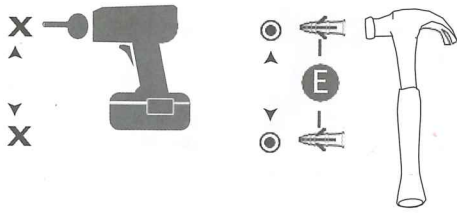

Step 3: Securing the rod supports

- Position and hold the larger rod support (A) over the marked positions on the left wall. Drill the screws into the wall.
- Repeat on the opposite wall, with rod support (B).

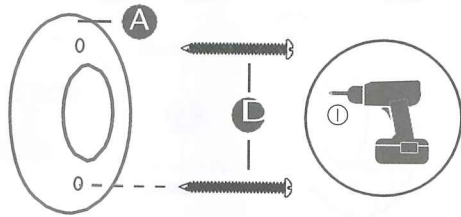

Step 4: Unlocking rod

- Hold the larger end of the expandable rod C in your left hand and the smaller end in your right hand. Twist the larger end away from you to unlock. (See instructions on sticker.)

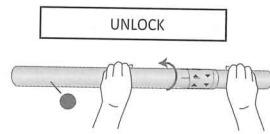

Step 5: Installing rod

- Extend rod and place ends into roDsupports. Make sure ends make full Contact with wall.
- Continue applying pressure outward and twist larger tube with your left hand toward you to LOCK ROD IN PLACE TIGHTLY. (see directional sticker)

