

Bouclair

Skus 9404817/9404818/9404819/9404820/9404821/9404822/
9404823/9404824/9404825/9404826/9404827/9404828/
9404829/9404830/9404831/9404832/9404833/9404834/
9404835/9404836/9404837/9404838/9404839/9404840/
9404841/9404842/9404843/9404844/9404845/9404846/
9404847/9404848/9404849/9404850/9404851/9404852

Bamboo Roman Blind INSTALLATION INSTRUCTIONS

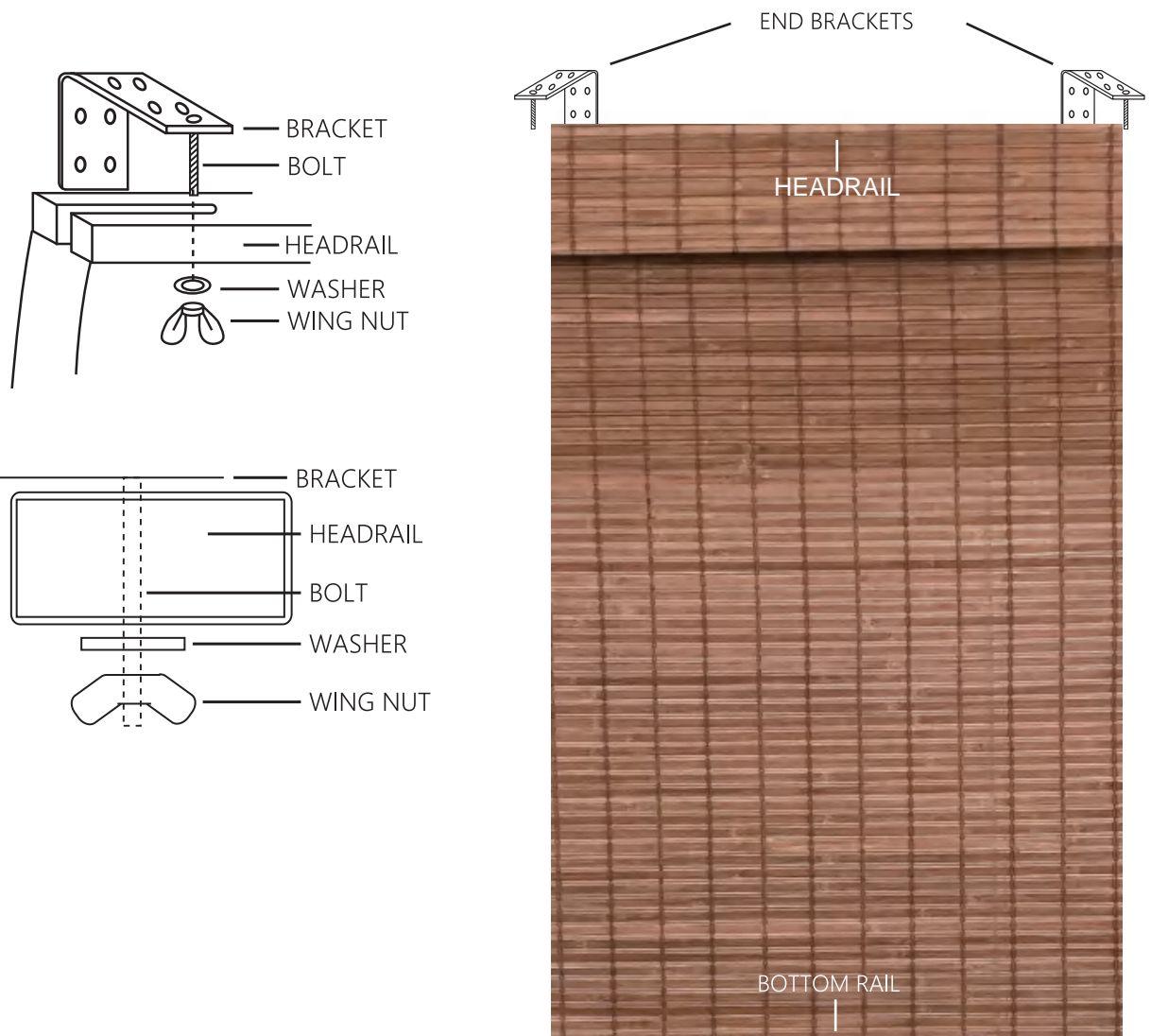

WARNING

STRANGULATION HAZARD — Young children can be strangled by cords. Immediately remove this product if a cord longer than 22 cm or a loop exceeding 44 cm around becomes accessible.

INSTALLING

STEP 1. Select the method of mounting that best suits your purpose (A, B or C).

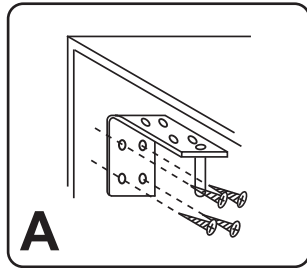

A. Mounting to the inside or between the sides of window frame.

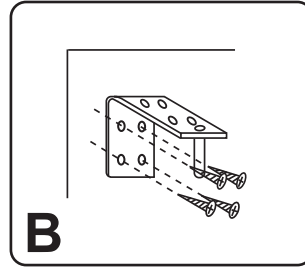

B. Outside mounting to the face or outside the window frame.

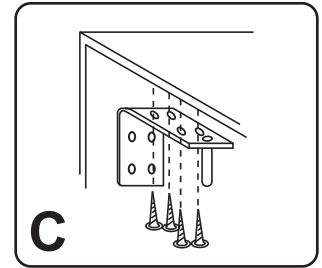

C. Ceiling mounting over a surface such as the upper inner part of a window frame or the ceiling.

STEP 2. Measure where you want the blind to hang, make sure that the blind is centered and level. Hold one bracket at the desired height and width you have chosen and mark the screw holes with a pencil.

STEP 3. Drill pilot holes where you marked the screw holes. Use a screwdriver to attach the bracket to the wall or ceiling using the screws provided.

STEP 4. After the first bracket is mounted, carefully position and attach the second bracket. Double check to be sure that it is level with the first bracket and that both are the correct distance apart.

STEP 5. Lift blind into place pushing headrail slot onto the bracket bolt (see fig 1). Make sure that the blind cord faces you. Place washer over bolt, then secure in position using wing nut (see fig 2).

STEP 6. Attach Child Safety Cord Cleat where required to prevent tangling or child strangulation.

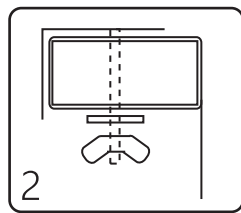
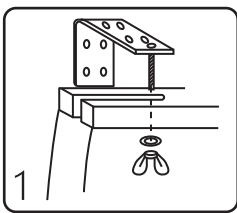

OPERATION

LOWERING: Pull the bottom rail downwards slowly until blind reaches the desired height.

RAISING: Pull the bottom rail upwards slowly until blind reaches the desired height.